

OUTLINE DIMENSION

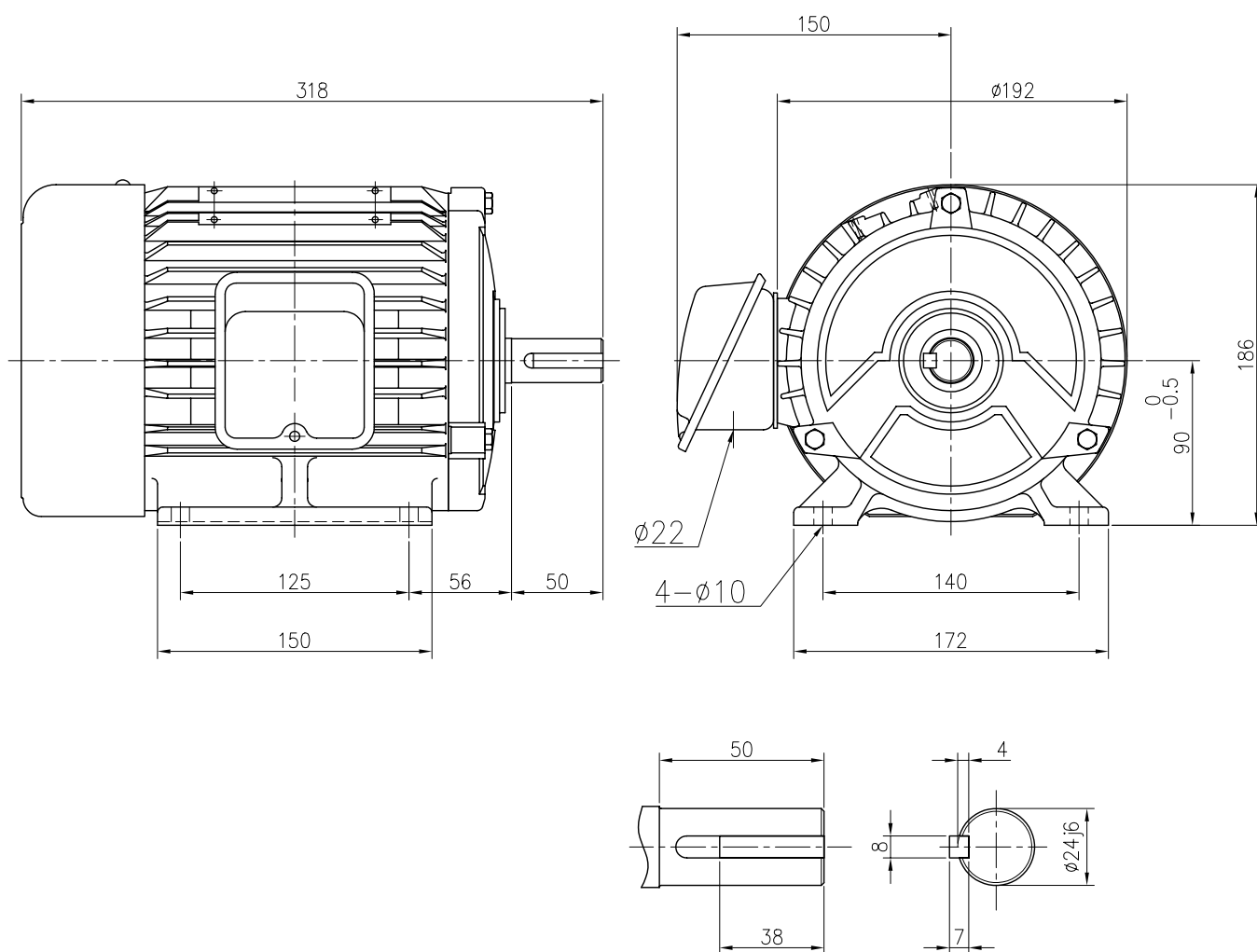

SHAFT EXTENSION

<NOTE>

1. TYPE : TEFC(Totally Enclosed Fan Cooled)

FOOT MOUNTED TYPE

2. THE TOLERANCE FOR THE KEY DIMENSIONS

IS IN ACCORDANCE WITH KS B 1311-84

3. THE TERMINAL BOX MAY BE ROTATED

STEPS OF 90°

4. CAST IRON FRAME AND END BRACKETS.

5. STAINLESS STEEL NAME PLATE WITH CONNECTION DIAGRAM.

6. STEEL FAN COVER AND TERMINAL BOX.

FRAME NO.	OUTPUT (kW)				INS. CLASS	PRO-TEC-TION	RA-TING	BEARING NO.						APPROX. WEIGHT (Kg)		
								2 P		4 P		6P / 8P				
	2P	4P	6P	8P				DRIVE	OPP.D.	DRIVE	OPP.D.	DRIVE	OPP.D.	2P	4P	6P/8P
90L	—	1.5	—	—	B	IP44	CONT.	—	—	6205ZZ	6204ZZ	—	—	—	24	—

UNIT	mm	SCALE	$\frac{N}{S}$	PROJECT'N	3rd Angle	TITLE	OUTLINE
DESIGNED		CHECKED		APPROVED			
2008.03.19 S.M.KIM		2008.03.19 H.K.KIM		2008.03.19 H.J.KIM		SUBJECT	90L, B3
HIGEN Motor Co., Ltd.						DWG. NO.	DW-KMI-02HV1